

CLEVIS INSULATOR

The CLEVIS INSULATOR ensures electrical isolation from the carrier pipe and its support. The insulators are generally used in conjunction with Non-Conductive Rollers.

Clevis Insulators can be used with any standard pipe hanger



CLEVIS INSULATOR COMPONENTS

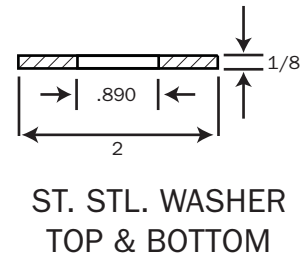
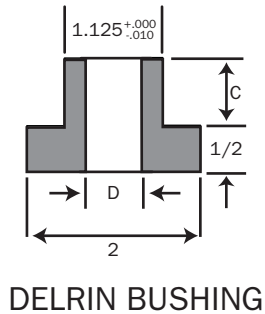
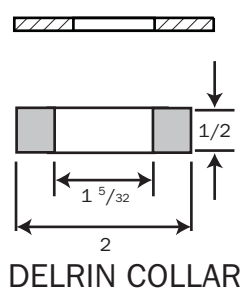

DIMENSIONS

Dimensions in inches

Pipe Diameter	Hanger Rod Diameter A	Clevis (Yoke) Stock Size B	Bushing Neck Height C	I.D. Bushing
2"	3/8	1/4 - 2 1/2	11/16	25/64
3"	1/2	1/4 - 2 1/2	11/16	33/64
4"	5/8	1/4 - 2 1/2	11/16	41/64
5"	5/8	3/8 - 2 1/2	27/32	41/64
6"	3/4	3/8 - 2 1/2	27/32	25/32
8"	7/8	3/8 - 2 1/2	27/32	57/64
10"	7/8	1/2 - 2 1/2	31/32	57/64
12"	7/8	1/2 - 3	31/32	57/64

PHYSICAL PROPERTY COMPARISON

PHYSICAL PROPERTIES	ASTM	UNITS	DELTRIN 150 E
Izod Impact (Notched) -40°F +73°F	D256	ft-lb/in	1.2 1.5
Tensile - Impact Strength	D1822 (long)	ft-lb/in ²	170
Flex Modulus (0.05 in/min) -68°F +73°F	D790	kpsi	640 425
Compressive Stress +73°F @ 10% def	D695	kpsi	18
Modulus of Elasticity	D638	kpsi	450
Flexural Strength, Yield +73°F	D790	kpsi	14.3
Poisson's Ratio	—	—	.35
Shear Strength +73°F	D732	kpsi	9.5
Tensile Strength (0.2in/min) -68°F +73°F	D638	kpsi	14.7 10
Tensile Elongation at Break -68°F +73°F	D638	%	38 60
Moisture Absorption Comparison	24 hr, 50% RH 24 hr Immersion	Delrin .25% Delrin .90%	Nylon 1.2% Nylon 8.0%