

ROLLER SOCKET

16B

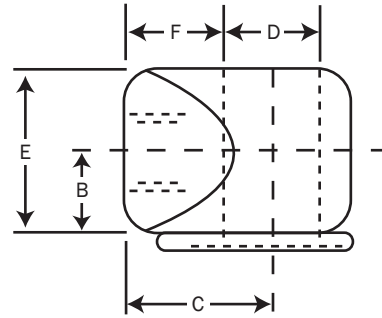
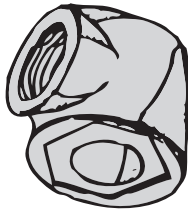

SIZE RANGE: 3/8" THRU 1 3/4" SHAFT THREAD

MATERIAL: IMPORTED AND DOMESTIC CAST IRON, CAST 304 & 316 STAINLESS STEEL

SERVICE: TO BE USED WITH ROLLER PIPE HANGERS

ORDERING: SPECIFY MODEL NUMBER, SOCKET SIZE NUMBER, SHAFT THREAD, NAME.

Dimensions in inches

Shaft Size Number	Shaft Size & Threads / inch Number A	B	C	Rod Size D	E	F	Weight / lbs. Per 100 Sockets
1	3/8 - 16	5/8	11/16	3/8	1 1/16	1/2	13
2	1/2 - 13	3/4	13/16	1/2	1 3/8	1/2	24
3	1/2 - 13	3/4	15/16	5/8	1 1/2	5/8	35
3	5/8 - 11	7/8	15/16	5/8	1 1/2	5/8	49
4	3/4 - 10	1	1 1/4	3/4	1 3/4	7/8	77
5	7/8 - 9	1 1/8	1 1/2	7/8	2 1/4	1 1/16	122
5	1 - 8	1 1/4	1 1/2	7/8	2 1/4	1 1/16	152
6	1 1/8 - 7	1 3/8	1 1/2	1	2 1/2	1	213
6	1 1/4 - 7	1 1/12	1 1/2	1	2 1/2	1	244
7	1 1/4 - 7	1 1/2	1 1/2	1 1/8	2 3/4	1	282
8	1 1/4 - 7	1 5/8	1 7/8	1 1/4	3 1/4	1 1/4	390
9	1 1/2 - 6	1 3/4	2 1/8	1 1/2	3 3/8	1 3/8	530
10	1 3/4 - 5	2 1/4	2 5/8	1 1/2	3 7/8	1 5/8	595

A = Diameter of Axle & Th reads per Inch

D = Diameter of Hanger Rod

Dimensions & Weights can vary slightly or change without notice